

Telesto® Series PS-OCT Systems

TELESTO SERIES PS-OCT PRECONFIGURED SYSTEMS		
ITEM #	TEL211PSC1 (/M)	TEL221PSC1 (/M)
Base Unit	TEL211PS	TEL221PS
Center Wavelength	1325 nm	1300 nm
Scanning System	OCTG13PS	
Scan Lens Kit	OCT-LK4	OCT-LK3
Reference Length Adapter	OCT-RA4	OCT-RA3
Accessories	OCT-STAND (/M) and OCT-XYR1 (/M)	

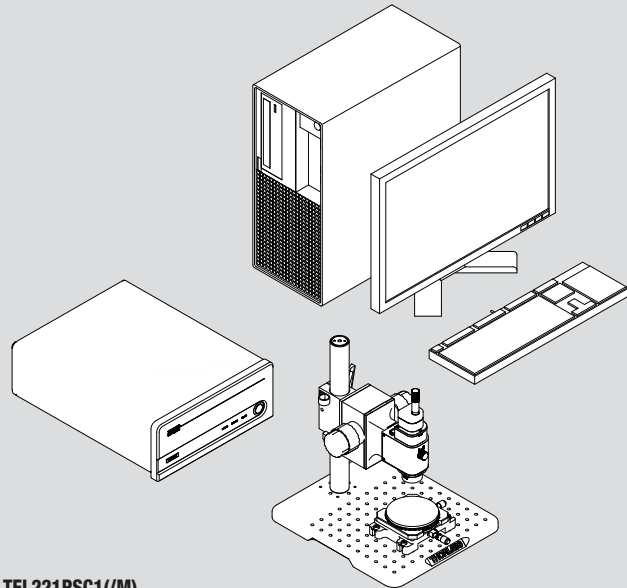

TEL221PSC1 (/M)

The TEL221PSC1 (/M) configuration consists of a TEL221PS high-resolution 1300 nm base unit, standard scanner, general-purpose scan lens kit, reference length adapter, stand, and stage.

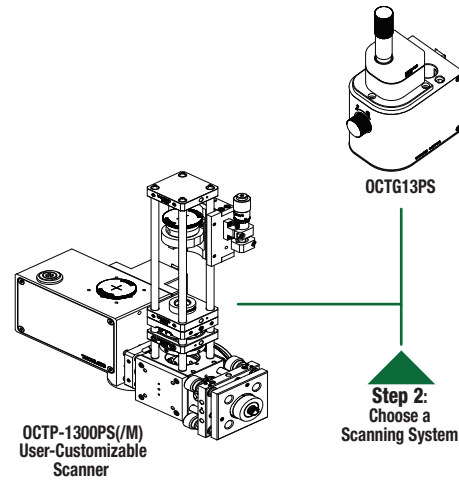

Step 2:
Choose a Scanning System

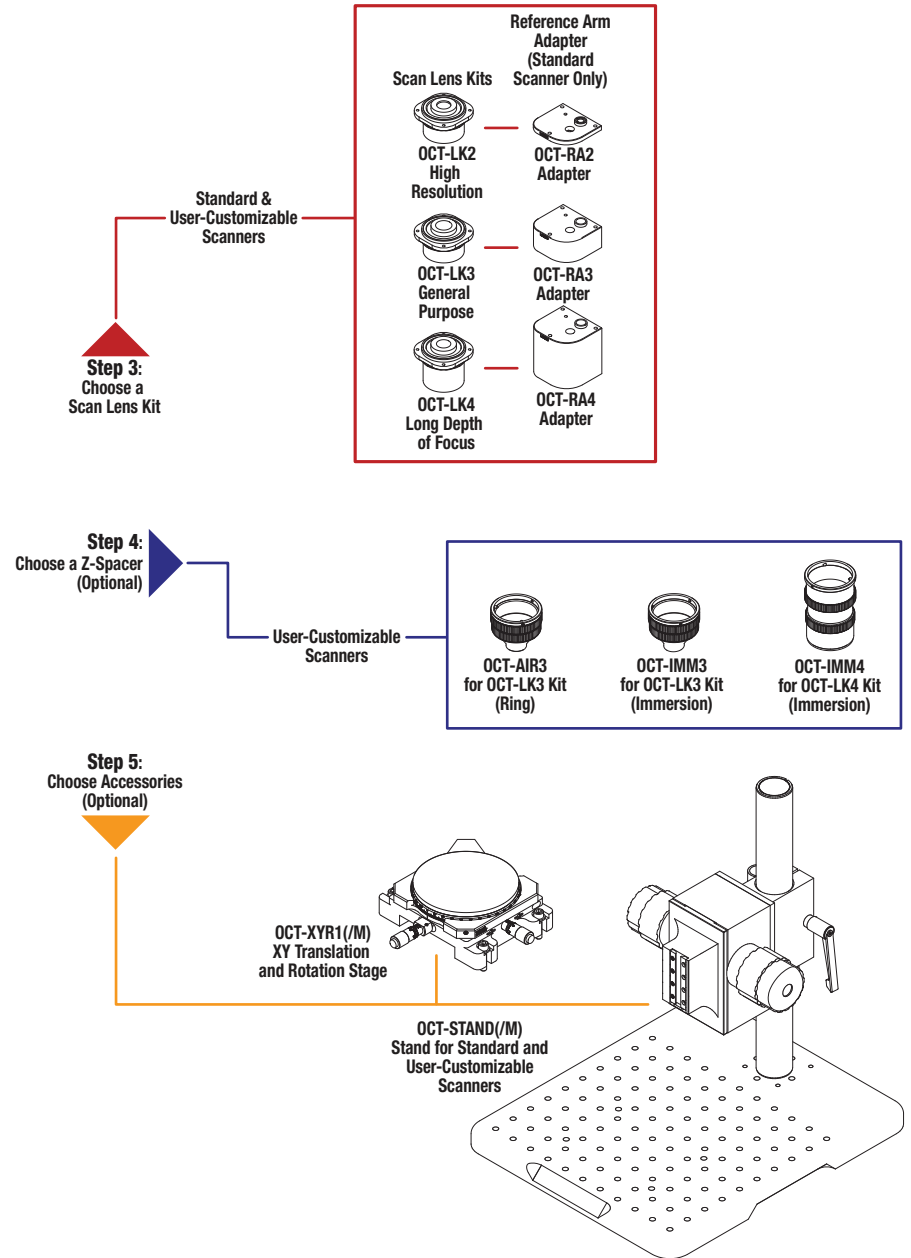
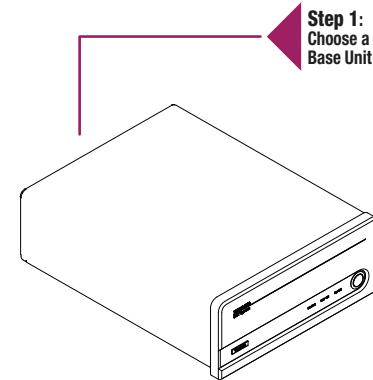

TELESTO SERIES PS-OCT BASE UNIT SPECIFICATIONS		
ITEM #	TEL211PS	TEL221PS
Center Wavelength	1325 nm	1300 nm
Imaging Depth (Air/Water)	7.0 mm / 5.3 mm	3.5 mm / 2.6 mm
Axial/Depth Resolution (Air/Water)	11 μm / 8.3 μm	5.5 μm / 4.2 μm
A-Scan/Line Rate	5.5 kHz to 76 kHz	
Sensitivity*	111 dB (at 5.5 kHz)	
Base Unit Dimensions	411.8 mm x 325.0 mm x 143.0 mm	

*Typical Values Measured Using a Common Path Probe with 50% Beamsplitter

Available Base Units:

- TEL211PS High-Depth Imaging
- TEL221PS High-Resolution Imaging